

Multimedia Projector EB-1775W / EB-1770W / EB-1760W / EB-1750				
SPECIFICATIONS				
Specification of Main Parts	LCD	Size	EB-1775W	
		Pixel Number	EB-1770W	
		Native Resolution	EB-1760W	
			EB-1750	
Projection Lens			0.59-inch x 3	
			1,024,000 dots (1280x800) x 3	
			WXGA	
Lamp	Type	Life	Powerd Focus & 1.2 × Optical zoom	
			Manual Focus & 1.2 × Optical zoom	
			F-number=1.58 - 1.7 / Focal Length =13.52 - 16.22mm	
Screen Size	Offset		230 W UHE	
			205 W UHE	
			230 W UHE	
Light Output*	Brightness Control Normal / Eco		4000 hours (Power Consumption: Normal) / 4000 hours (Power Consumption: ECO)	
			"30"" to 300" [0.67 to 6.81 m]	
			"30"" to 300" [0.72 to 7.30 m]	
Color Light Output*			10:1	
			7.9:1	
			3000 lm / 1700 lm	
Contrast			2600 lm / 1700 lm	
			2600 lm	
			2000:1	
Sound Output			1W Monaural	
			Yes (Auto / Manual)	
			Yes (Auto / Manual)	
Keystone Correction	Vertical	Horizontal	Yes (Manual)	
			Yes	
			N/A	
Screen Fit	Input Terminal	Video	D-sub 15pin x 1	
			Stereo mini jack x 1	
			Composite Video: RCA (Yellow) x 1	
Video	Input Terminal	Video	Component Video: D-sub 15pin Blue molding (corresponds with Analog RGB connector)	
			RGB Video: D-sub 15pin Blue molding (corresponds with Analog RGB connector)	
			Stereo mini jack x 1 (corresponds with Analog RGB connector)	
Digital Input Terminal	USB I/O	Terminal	HDMI x 1	
			N/A	
			USB Type B x 1	
Control			USB Ver. 2.0	
			USB Type A x 1 (for USB Memory, Document Camera)	
			USB Ver. 2.0	
Memory			N/A	
			USB Type A x 1	
			IEEE 802.11b: 11 Mbps**	
Network for Projection	Wired LAN	Terminal	IEEE 802.11g: 54 Mbps**	
			IEEE 802.11n: 130 Mbps**	
			N/A	
PC Applications			EasyMP Monitor (for Windows)***	
			EasyMP Network Projection (for Windows,Mac OS X)***	
			USB Display (for Windows,Mac OS X)	
Operating Temperature			QuickWireless Connection (for Windows)	
			QuickWireless Connection (for Windows)****	
			EasyMP Slide Converter (for Windows)***	
Operating Altitude			5 °C to 35 °C <41 °F to 95 °F	
			0 m to 2286 m<0 ft to 7500 ft>(over 1500 m / 4,921 ft :with High altitude mode)	
			less than7.2 seconds	
Start-Up period			Yes	
			Yes	
			Instant off	
Direct Power On			100 - 240 V AC +/- 10%, 50/60 Hz	
			322 W	
			293 W	
Direct Power Off			322 W	
			0.38 W(Network Off)	
			304 W	
Cool-Down Period			278 W	
			304 W	
			0.44 W(Network Off)	
Power Supply Voltage			210 x 292 x 44 mm	
			Approx. 3.77 lbs. / 1.71kg	
			Approx. 3.7 lbs. / 1.68kg	
Power Consumption	100-120V	Lamp on	Approx. 3.77 lbs. / 1.71kg	
			Approx. 3.7 lbs. / 1.68kg	
			Approx. 3.7 lbs. / 1.68kg	
Stand by			Approx. 3.66 lbs. / 1.66kg	
			37dB / 30dB	
			40dB / 30dB	
Dimensions	Exclude Feet (D x W x H)		40dB / 30dB	
			40dB / 30dB	
			40dB / 30dB	
Weight			40dB / 30dB	
			40dB / 30dB	
			40dB / 30dB	
Fan Noise	Brightness Control : Normal / Eco		40dB / 30dB	
			40dB / 30dB	
			40dB / 30dB	

*Light Output / Color Light Output / Contrast --- Color mode: Dynamic, Zoom: Wide
**Maximum speed and range is achievable when used with same enhanced mode technology. Actual data rates, features and performance may vary depending on your computer system, and environment.
***Supplied on included CD-ROM
****Supplied as an option

SUPPLIED ACCESSORIES

Power Cable	3.0m
Remote Control	With AA type alkaline batteries x2pcs
Computer Cable	1.8m <6 ft>, AHD-15 pin type slim-cable
USB Cable	3.0m(1775W/1770W/1760W), 1.8m(1750)
Soft Carrying Case	
Password Protect Sticker	
User's Manual	
EPSON Projector Software (CD-Rom)	
Quick Wireless Connection USB Key	ELPAP08 (1775W)
Wireless LAN Unit	ELPAP07 (1775W)

OPTIONAL ACCESSORIES

ELPLP65	Spare Lamp
ELPAF31	Air Filter Set
ELPAP08	Quick Wireless Connection USB Key
ELPAP07	Wireless LAN Unit
ELPDC06	USB Document Camera

Bold, Bright, Beautiful...3LCD Technology

3LCD technology achieves bright, natural images and smooth, sharp video playback. No color break-up makes images gentle on the eyes.



Optical unit with high light-use efficiency

WARRANTY SERVICE

2 Years Onsite Warranty Service to be provided for local purchase only.



The warranty service can be extended by purchasing Epson Coverplus Extended Warranty. For more information, please contact Epson customer support.

CONNECTOR PANEL



EB-1775W/1770W/1760W



EB-1750

- 1 Video Input
- 2 Computer Input
- 3 USB (Type B)
- 4 USB (Type A)
- 5 HDMI
- 6 Audio Input



Multimedia Projector

EB-1775W **EB-1770W**
EB-1760W **EB-1750**



The Complete, truly mobile projector



The Complete, truly mobile projector

Are you having some concerns with regard to projectors?

Issues like size, weight, ease of use, etc...

The Epson EB-1750 series aims to resolve these issues with its rich and useful functions that are easy to use and a clean yet simple look to suit any environment. This compilation of features allow the audience to concentrate on the presentation materials.

Multimedia Projector

EB-1775W / EB-1770W / EB-1760W / EB-1750

The Complete, Truly mobile projector

Portability

Very slim and lightweight for easy carrying

Put on a great show wherever you present.

Having only 44mm* height, weight just 1.7kg. This projector is easy to take with you anywhere and always gets your message across with sharp, colourful images that are clear and bright even in daylight rooms. *Excluding feet



Clearly visible images even under fluorescent lights

3000 lm High Brightness

With a high 3000 lm brightness setting you don't have to draw the curtains for rooms of up to 50 people. It's possible to use it in an office or classroom without dimming the lights. Its 1.7kg weight makes it easy to take it with you.

Put away smoothly

Instant Off and Direct Power Off

With desktop use it is fine to turn off the switch immediately after use. There is no need to keep your audience waiting for cool down, allowing you to prepare for your next class or meeting for more efficient use of time.



Convenient Functions Epson provides even with Mobile use Projector

Usability

Easy to adjust projected images

Auto H/V Keystone Correction

Simply turn on the power and direct the projector toward the screen or wall and the image will be automatically corrected in just a couple seconds. The focus is also automatically adjusted at the same time for a prompt completion of set-up. (Horizontal auto keystone correction: only for EB-1775W)

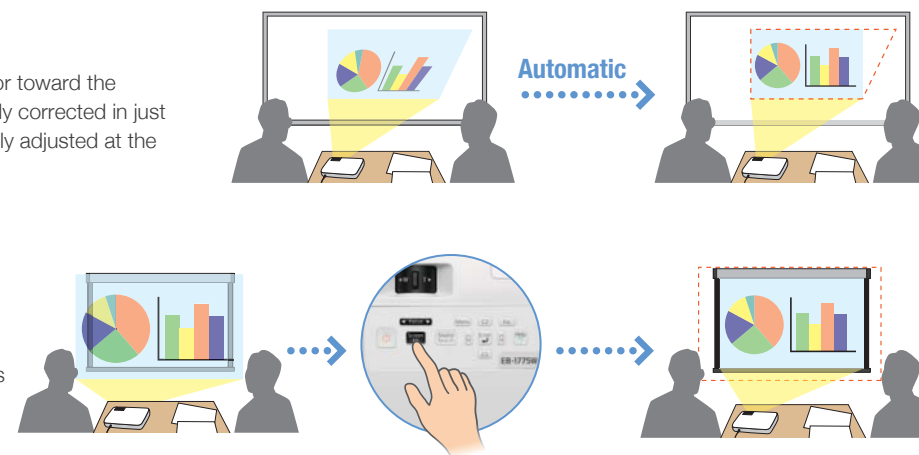

Screen Fit

In cases where the image extends beyond the frame of the screen or whiteboard you just have to push the Screen Fit button and the image frame will automatically match up with the edges of the screen. Focus is, of course, adjusted automatically as well. (For EB-1775W)

Short throw distance

Makes your workspace larger.

Project a 60 inch screen from just 1.35m*. This convenient feature is great for small meeting room and allows for efficient use of desk space. (* XGA mode is 1.45m)

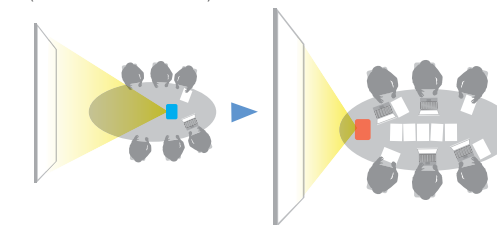

Comfortable during operation

Front Exhaust

The projector was designed to prevent anyone from being exposed to the hot exhaust even when on a narrow table.

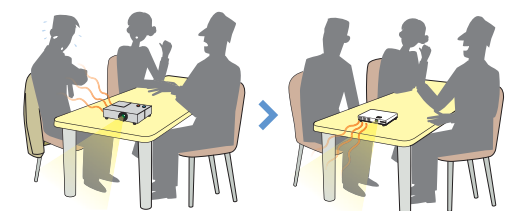

Useful features allows

Expandability

No special settings required for projection with a PC

3 in 1 USB Display

A troublesome set-up is no longer necessary for image projection. Images can be projected by simply connecting the PC and projector via the included USB cable. Sound data can also be sent*. A built-in speaker allows you to enjoy powerful sound without having to prepare a separate speaker.

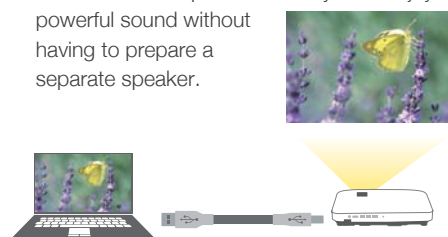

Safety with wireless

Wireless Connection

Free from complicated and dangerous cables! A wireless LAN connection is possible via an access point*. You can make a direct connection between projector and a PC. Sound can also be transmitted wirelessly with projector, so that it isn't necessary to connect an audio cable. *Excluding EB-1750

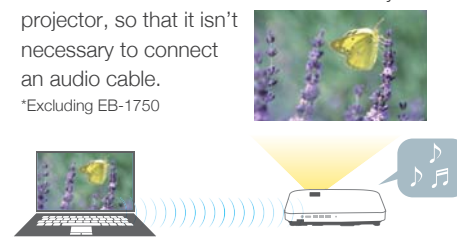

Farewell to heavy PCs

PC Free

Using the included "Slide Converter" software, presentations are possible without a PC using a USB memory device. You can just bring the data along without any distractions.



Easy to share pictures

Slide Show

Simply save pictures as JPEG data on a USB memory device, insert into the projector and your pictures are projected automatically. The viewer can see beautiful pictures projected as they are for a more dramatic impression.



Choose from a variety of sources

Wide-ranging Connectivity

Wider range of connectivity allows for more effective presentations. Depending on the situation, you can choose from a variety of connection methods including USB, HDMI and wireless connection*. It is also possible to connect Epson's ELPDC06 document camera with a USB cable. *Excluding EB-1750

