



# QDX

## Quick Start Guide

### Environment conditions

Environment	Operating	Non-Operating
Ambient temperature	Temporary event: 0°C (32°F) to 40°C (104°F) Permanent install <sup>1</sup> : 5°C (41°F) to 30°C (86°F)	-10°C (-14°F) to 60°C (140°F)
Humidity	0% RH to 80% RH Non-condensed	5% RH to 90% RH Non-Condensed
Altitude	0 m (0 ft) to 3000 m (9843 ft)	-60 m (-197 ft) to 5000 m (16404 ft)
Air cleanness	Clean office environment <sup>2</sup>	n.a.
Air clearance	Air outlets: minimum 60 cm (2 ft) Air inlets: minimum 10 cm (4 inch)	n.a.
Air exhaust	Nominal: 140 l/s (300 CFM) Maximum: 300 l/s (650 CFM)	n.a.

### Main Power requirements

- The projector operates from a nominal mono phase power net with a separate earth ground PE.
- Power requirements : 100-160 V (reduced power) / 200-240 V~, 22 A, 50/60 Hz.
- The projector must be grounded.
- The power cord delivered with the projector must be used.

### Local keypad overview

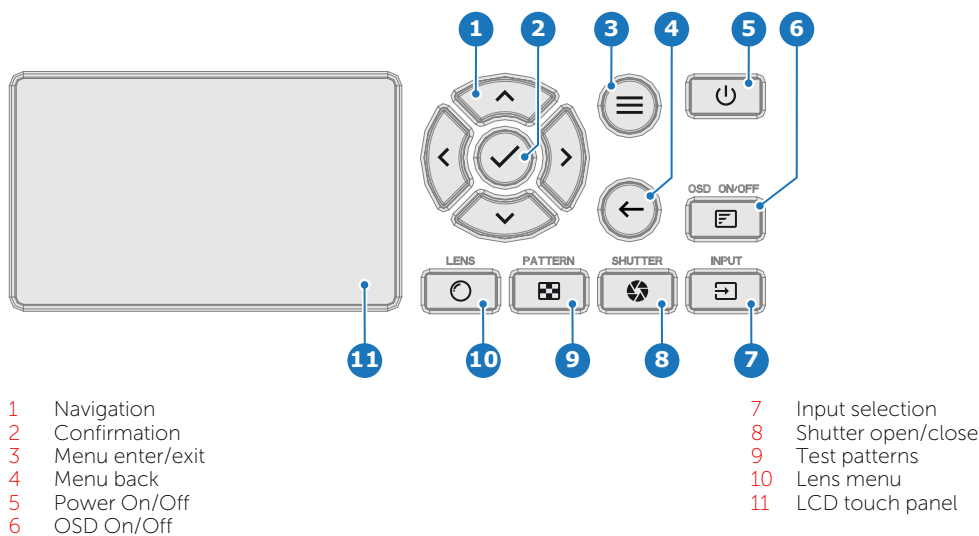

1. Recommended temperature range for fixed installs  
2. Equivalent with cleanroom standard ISO 14644-1 ISO Class 9. If not, an environment protection housing must be used.



## Pulse Remote Control Unit

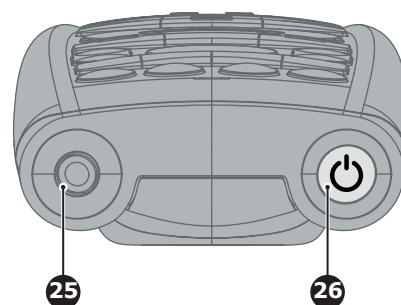
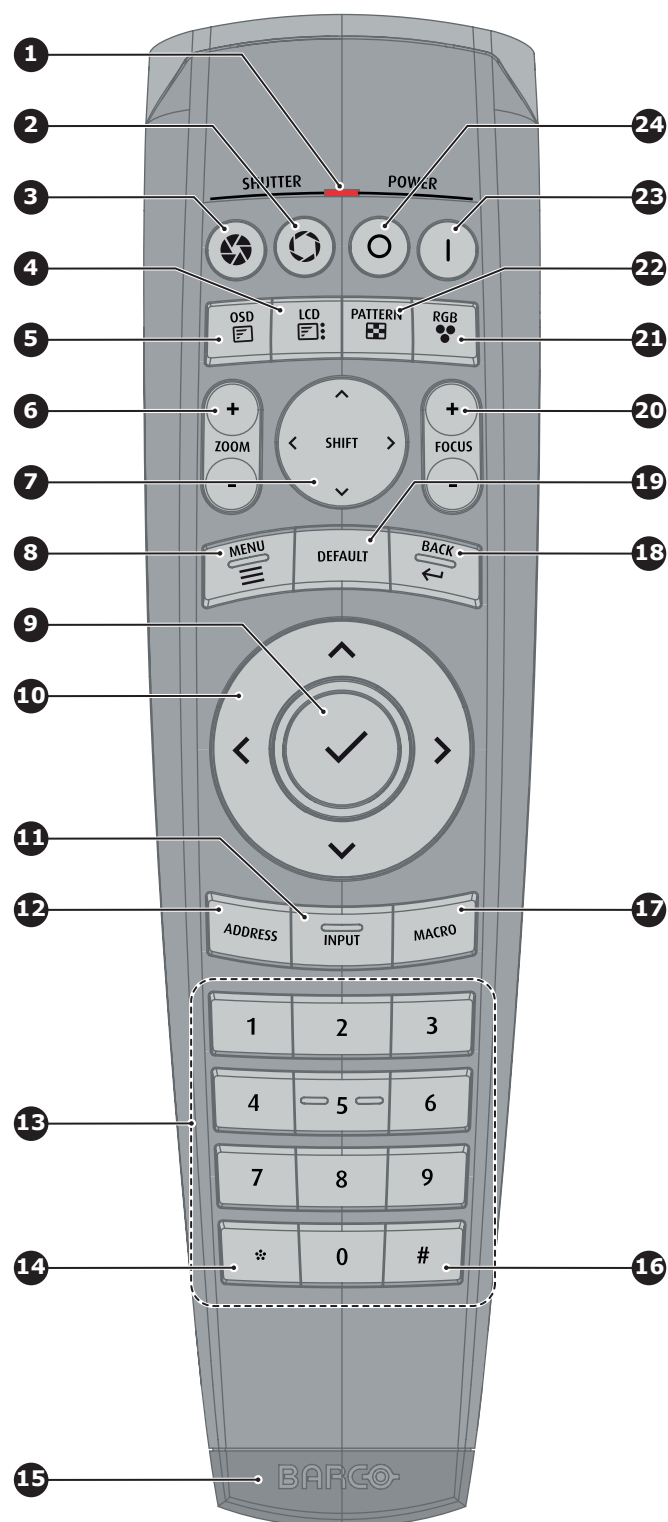

- 1 Button pressed indicator
- 2 Shutter open
- 3 Shutter close
- 4 LCD panel on / off
- 5 Project OSD on / off
- 6 Lens zoom
- 7 Lens shift
- 8 Menu open / close
- 9 Menu selection, OK button
- 10 Menu navigation
- 11 Input selection
- 12 Address button
- 13 Numeric buttons
- 14 Backspace (while entering values)
- 15 XLR connector
- 16 Decimal mark (while entering values)
- 17 Macro button
- 18 Menu back
- 19 Default value button
- 20 Lens focus
- 21 RGB filter
- 22 Test patterns
- 23 Power on
- 24 Power off
- 25 3.5 mm jack
- 26 RCU on / off



**CAUTION:** Replace batteries with the correct battery type. Use AAA size batteries for the basic RCU and AA size batteries for the Pulse RCU. There is a risk of explosion if the battery is replaced with an incorrect type. Use alkaline batteries for optimum range and life time. Make sure the polarities match the + and - marks, as depicted on the inside of the battery compartment. There is a risk of explosion if the batteries are installed incorrectly.



Replacing batteries will reset the broadcast address of the Pulse RCU to its default value '0'. Replacing batteries of the Pulse RCU switches on the Pulse RCU automatically.



In order to make sure you can control your projector remotely, Barco has provided a basic remote control unit in case the Pulse RCU is not available to you. While the basic remote control has a more limited amount of available features, it will be able to help you out with basic controls.

## Available lenses for the QDX projector

Order No	Name (Screening)	Image	Resolution	Throw Range
R9801661	TLD+ 90° UST (0.39) Fixed focal		WUXGA 0.9" 4K 0.9"	( 0.38 : 1 ) ( 0.41 : 1 )
R9862001	TLD+ 90° ST (0.65 - 0.85)		WUXGA 0.9" 4K 0.9"	( 0.67 - 0.88 : 1 ) ( 0.72 - 0.94 : 1 )
R9801414	TLD+ (0.85 - 1.15)		WUXGA 0.9" 4K 0.9"	( 0.86 - 1.25 : 1 ) ( 0.93 - 1.33 : 1 )
R9862005	TLD+ (1.14 - 1.39)		WUXGA 0.9" 4K 0.9"	( 1.16 - 1.49 : 1 ) ( 1.24 - 1.60 : 1 )
R9862010	TLD+ (1.39 - 1.8)		WUXGA 0.9" 4K 0.9"	( 1.39 - 1.89 : 1 ) ( 1.49 - 2.02 : 1 )
R9862020	TLD+ (1.8 - 2.6)		WUXGA 0.9" 4K 0.9"	( 1.88 - 2.57 : 1 ) ( 2.01 - 2.75 : 1 )
R9862030	TLD+ (2.6 - 4.1)		WUXGA 0.9" 4K 0.9"	( 2.51 - 4.12 : 1 ) ( 2.69 - 4.41 : 1 )
R9862040	TLD+ (4.1 - 6.9)		WUXGA 0.9" 4K 0.9"	( 4.08 - 6.86 : 1 ) ( 4.37 - 7.35 : 1 )
R9829997	TLD+ (6.9 - 10.3)		WUXGA 0.9" 4K 0.9"	( 6.74 - 10.11 : 1 ) ( 7.22 - 10.83 : 1 )

## Install the projection lens

1. Place the lens holder in the “unlocked” position as follows:
  - a) Pull the primary lens lock handle (reference 1) outward and then towards the electrical socket (reference 2).
  - b) Pull the secondary lens lock (reference 3) slightly outwards until you hear an audible clicking sound.

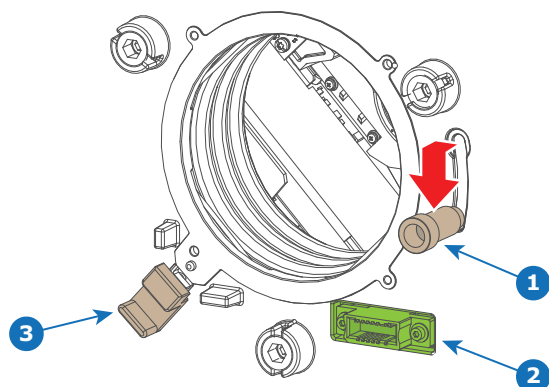

2. Gently insert the projection lens in the lens holder while aligning the lens connector with the electrical socket (reference 2) until a click is heard.

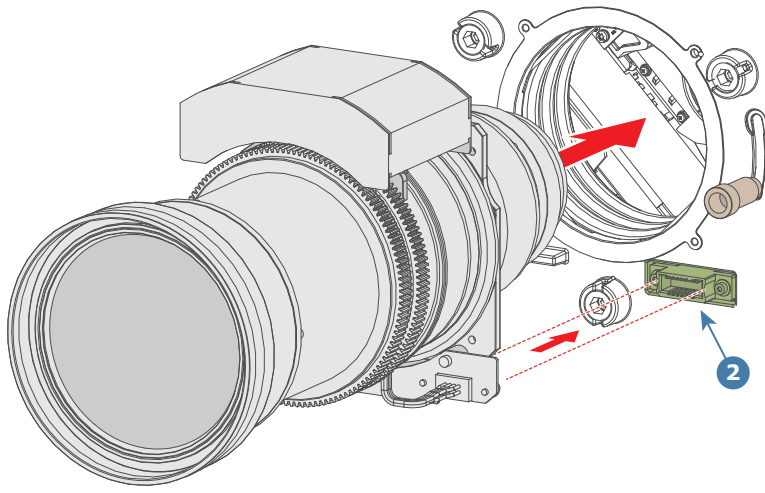

3. Secure the lens by sliding the primary lens lock handle to the “locked” position.

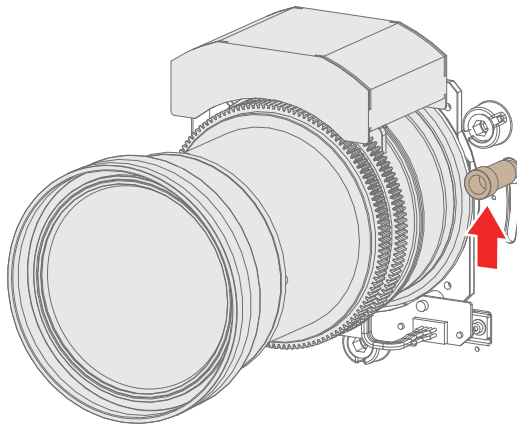

4. Check if the projection lens is secured by trying to pull the projection lens out of the lens holder.

## Power up the projector

1. Connect the power cord to the power inlet of the projector.

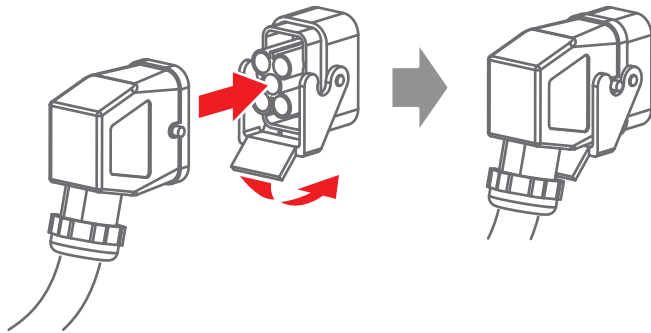

2. Turn the mains switch to on ( I ).

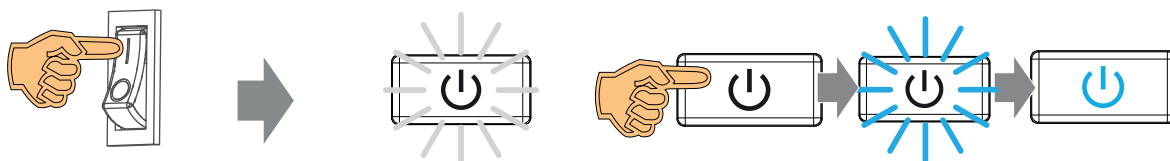

The projector will perform the startup sequence. When ready, the power button on the local keypad will illuminate white, meaning that the projector is in **READY** mode.

3. Press the Power On/Off button on the local keypad, or the Power On button on the remote control. The power button will after some seconds illuminate solid blue, meaning that the projector is **ON**.



## Button backlight status

The Power and Shutter buttons are equipped with white, blue and red backlit LEDs. The other keys are only equipped with white and blue backlit LEDs. The LEDs are controlled according to the features available.

Button	Color status	Description
	Short WHITE pulse	Projector starts up (booting), or is in ECO STANDBY
	Blinking WHITE	Firmware update, or in transition from ECO STANBY to STANDBY
	Solid WHITE	Projector is in STANDBY or READY mode
	Blinking BLUE	Projector goes to ON mode
	Solid BLUE	Projector is ON
	Blinking RED	Error condition
	Off (no color)	Projector is OFF, starts up, or is in STANDBY or READY mode
	Solid WHITE	Projector is ON, shutter is open
	Solid RED	Projector is ON, shutter is closed

## Connecting with Pulse Prospector

Make sure both the connected device (e.g. laptop) and the projector operate within the same network (or has full access to the projector network).

- Open a browser and enter the IP address of the projector (default projector IP address is 192.168.1.101).  
 *Tip:* The projector IP address is visible on the Dashboard of the projector LCD touch panel.
- Log in using user name and password. See following table for default user names and passwords.

User group	Default user name	Default password	Default PIN <sup>3</sup>
End user	user	default1234	69905
Power user	poweruser	default1234	292920
Administrator	admin	default1234	297081

 *Note:* User names, passwords, and pins can be managed through the User account management system in Pulse Prospector. For detailed info see user guide Pulse Prospector.

## Front panel Control & Communication module

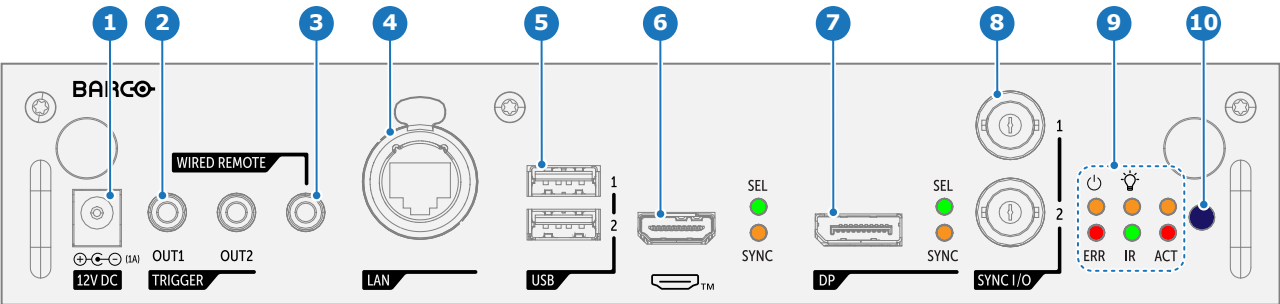

- 1

12V DC
- 2

TRIGGER
- 3

WIRED REMOTE
- 4

LAN
- 5

USB
- 6

HDMI™
- 7

DP
- 8

SYNC I/O
- 9

Projector status LEDs
- 10

IR receiver

3. Pin authentication is default disabled. To activate, see user account management system in Pulse Prospector.

## Front panel Quad Combo Input Mk III

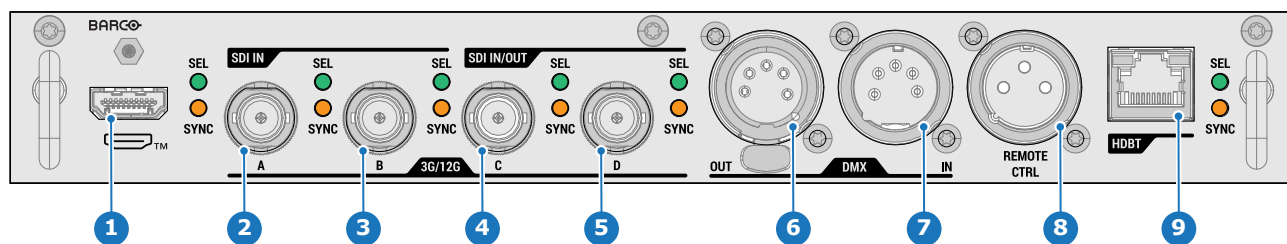

- |   |   |   |                                 |
|---|---|---|---------------------------------|
| 1 | HDMI™ input <sup>4</sup>                | 6 | DMX interface input             |
| 2 | Quad SDI channel A: 3G/12G input        | 7 | DMX interface output            |
| 3 | Quad SDI channel B: 3G/12G input        | 8 | XLR for wired projector control |
| 4 | Quad SDI channel C: 3G/12G input/output | 9 | HDBaseT input                   |
| 5 | Quad SDI channel D: 3G/12G input/output |   |                                 |

## Front panel Quad DP 1.2 input

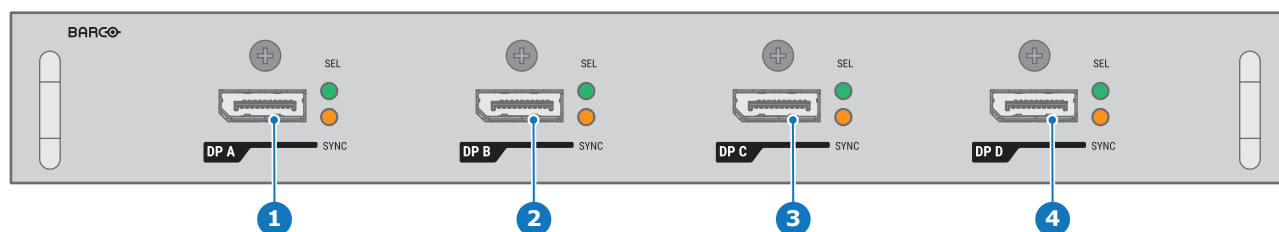

- |   |                                  |
|---|----------------------------------|
| 1 | Quad DisplayPort channel A input |
| 2 | Quad DisplayPort channel B input |
| 3 | Quad DisplayPort channel C input |
| 4 | Quad DisplayPort channel D input |

## Connect and select source

- Connect** available sources to the appropriate input ports.
- Select** connected source. (See Pulse OSD user guide for detailed menu navigation steps).
  - Select** LED (reference 1)
    - GREEN : port configured as input. Image appears on the screen.
    - Blinking GREEN : bidirectional port configured as output / loop-through.
  - Sync** LED (reference 2)
    - YELLOW : sync/signal is present.
    - Blinking YELLOW: Sync/signal is present, but not conform with input port standard.

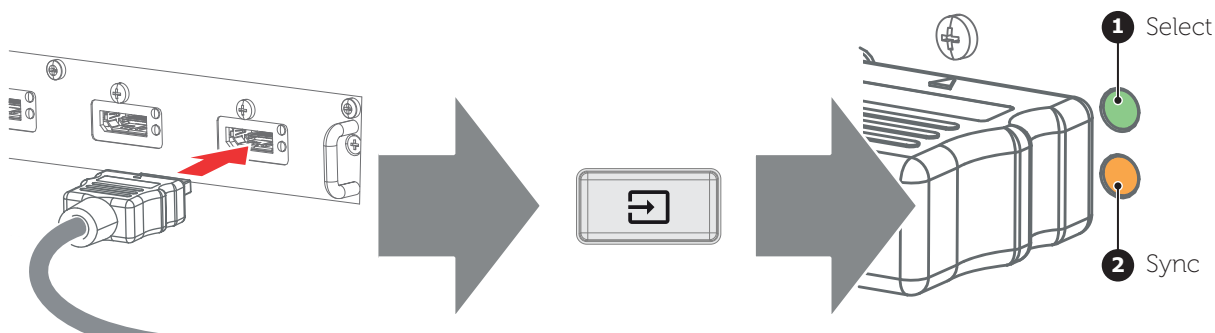

## Adjust

- Adjust the lens settings** by pressing the lens menu button on the keypad or via the zoom, shift and focus buttons on the keypad.





4. The terms HDMI, HDMI High-Definition Multimedia Interface, HDMI trade dress and the HDMI Logos are trademarks or registered trademarks of HDMI Licensing Administrator, Inc.

2. **Orientation** of the unit is set as standard in table front projection mode.  
Change the projector set up in the *Installation > Position > Orientation* menu.
3. For **Advanced adjustments** like Warping, Light management, etc. see Pulse OSD user guide.

## Projector status indicator LEDs

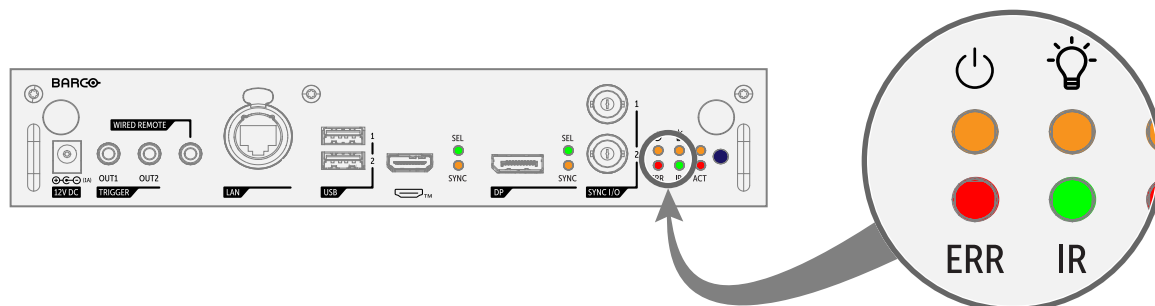
The Control & Communication module contains four status LEDs at the right side of the front panel. These LEDs allows a quick status analyses of the projector. For explanatory see table hereunder.



LED	Color status	Description
 Power	Off	Projector is in ECO STANDBY mode, or is powering up
	RED	Projector is in STANDBY mode
	ORANGE	Projector is in READY mode
	GREEN	Projector is ON
 Illumination	Off	Light source is OFF
	RED	No light source detected
	ORANGE	Light source is on in ECO mode
	GREEN	Light source is on in normal mode
ERR	GREEN-ORANGE	Light source is on in CLO mode
	Off	No error
	RED toggles on/off	Error
IR	ORANGE toggles on/off	Warning
	RED	IR signal received
	GREEN	IR signal acknowledged

## Power down the projector

1. While the projector is in **ON** mode, press and hold the Power On/Off button on the local keypad, or the Power Off button on the remote control, to shut down the light source of the projector.

The power button illumination will become white, and the projector will enter the cool down mode for approximately 30 seconds.

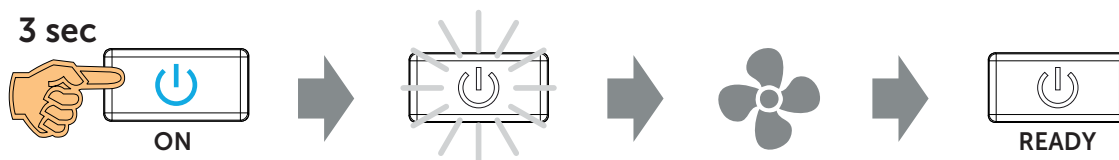

2. While the projector is in **READY** mode, press and hold the Power On/Off button on the local keypad, or the Power Off button on the remote control, to bring the projector in the **STANDBY** mode.
3. While the projector is in **STANDBY** mode, press and hold the Power On/Off button on the local keypad, or the Power Off button on the remote control, to bring the projector in the **ECO STANDBY** mode.



## Power transition diagram

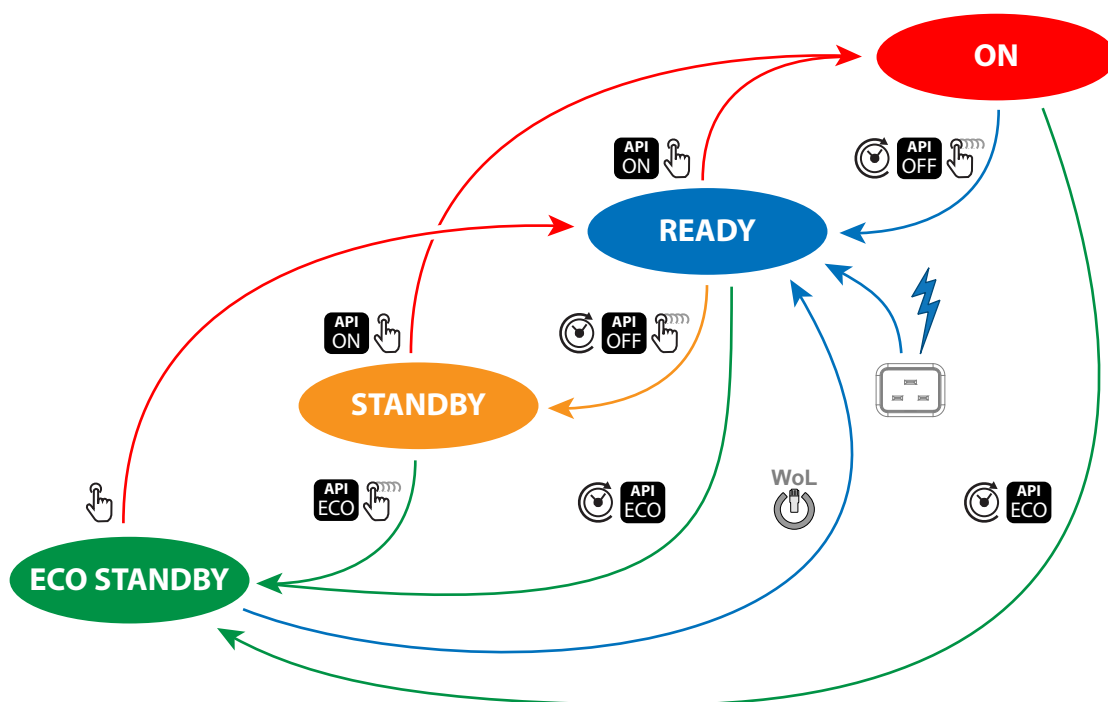

Symbol	Description
	Short pressing the Power on/off button on the local keypad or on the remote control unit.
	Long pressing the Power on/off button on the local keypad or on the remote control unit.
	Wake-On-LAN (WOL). Only works if a network was connected with the LAN port of the projector while the projector went to <b>ECO STANDBY</b> .
	API command to change the power state of the projector (Power ON, Power OFF, Go to ECO). See Pulse user guide for more info (E.g. PJLink).
	<b>Auto light source off</b> and <b>auto standby</b> features. Default disabled (factory settings). For configuration see power saving settings in the Pulse user guide.
	The projector starts default up in <b>READY</b> mode when it is powered.

## Remove the projection lens

- Support the projection lens with one hand while unlock the lens holder as follows:
  - Place primary lens lock handle (reference 1) in the “unlocked” position.
  - Pull the secondary lens lock (reference 3) outwards.
- Gently pull the projection lens out of the lens holder.

